

NOTES
 This drawing is copyright and must not be reproduced without the written permission of the designer.
 Contractors are to check all sizes and dimensions before setting out any site or shop work. Any errors or discrepancies to be reported to the designer.
 CDM 2015 Designers Risk Assessment
 All works to be carried out under CDM regulations.
 Contractor to ensure all relevant codes of practice and regulations for the proposed works are adhered to. No residual risk within the attached design unless specifically stated with the attached schedule.
 Do not scale off this drawing.

REVISIONS
 DATE
 00.00.00

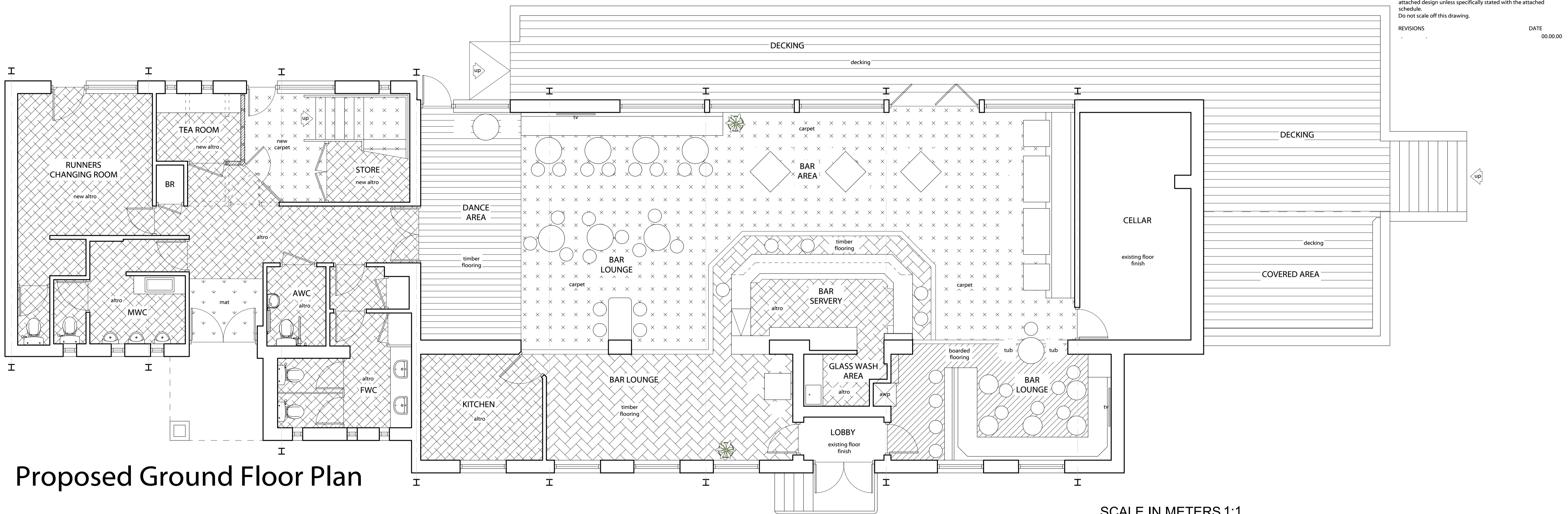

Proposed Ground Floor Plan

SCALE IN METERS 1:1

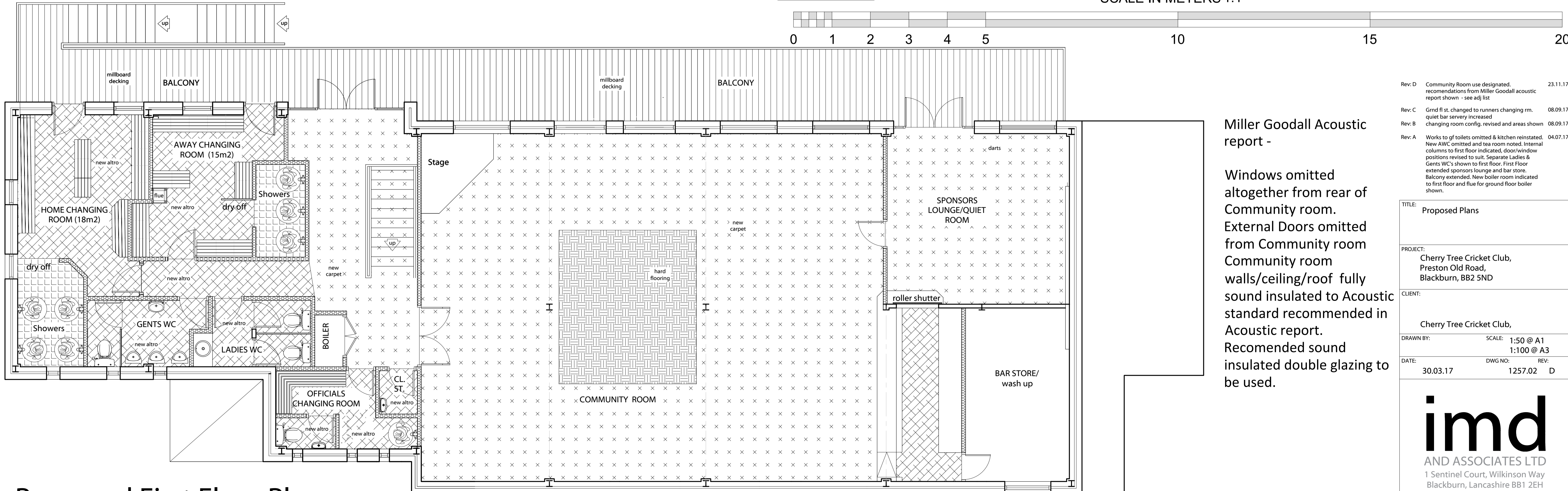

Proposed First Floor Plan

Miller Goodall Acoustic report -

Windows omitted altogether from rear of Community room.
 External Doors omitted from Community room
 Community room walls/ceiling/roof fully sound insulated to Acoustic standard recommended in Acoustic report.
 Recommended sound insulated double glazing to be used.

- Rev: D Community Room use designated. recommendations from Miller Goodall acoustic report shown - see adj list 23.11.17
- Rev: C Grnd fl st. changed to runners changing rm. quiet bar servery increased 08.09.17
- Rev: B changing room config. revised and areas shown 08.09.17
- Rev: A Works to gf toilets omitted & kitchen reinstated. New AWC omitted and tea room noted. Internal columns to first floor indicated. door/window positions revised to suit. Separate Ladies & Gents WCs shown to first floor. First Floor extended sponsors lounge and bar store. Balcony extended. New boiler room indicated to first floor and flue for ground floor boiler shown. 04.07.17

TITLE:	Proposed Plans		
PROJECT:	Cherry Tree Cricket Club, Preston Old Road, Blackburn, BB2 5ND		
CLIENT:	Cherry Tree Cricket Club,		
DRAWN BY:	SCALE:	1:50 @ A1	
		1:100 @ A3	
DATE:	DWG NO:	REV:	
30.03.17	1257.02	D	

imd
 AND ASSOCIATES LTD
 1 Sentinel Court, Wilkinson Way
 Blackburn, Lancashire BB1 2EH
 t: 01254 696989 e: info@imdandassociates.co.uk